

New



GANDUS UNICA

PNEUMATIC IMPULSE SEALER

ISO 11607.2 FULLY VALIDATABLE

VENTURI AIR SUCTION SYSTEM

TRACEABILITY FROM EXTERNAL NETWORK

7" COLOUR TOUCH SCREEN AND REMOTE SETTING

VIA APP WITH NO CABLE CONNECTIONS

UNICA IS THE NEWEST GANDUS PNEUMATIC IMPULSE SEALER.

STAINLESS STEEL CONSTRUCTION

DOUBLE SEALING BAR

VALIDATABLE VERSION ACCORDING TO ISO 11607 RULES

VENTURI AIR SUCTION SYSTEM WITH 1 NOZZLE SETTABLE POSITION FROM 0-150 MM LONG.

THIS INNOVATIVE SYSTEM ALLOWS AN EXTREMELY ACCURATE SUCTION ON ALL BAG DIMENSIONS AND FOR ANY LEVEL OF FILLING.

APPLICATIONS

SUITABLE FOR SEAL ALL HEAT-SEALABLE MATERIALS, WHICH GENERALLY FINDS APPLICATION IN THE MEDICAL, PHARMACEUTICAL, LIFE SCIENCE, LABORATORY AND CHEMICAL INDUSTRY FIELDS.

TRACEABILITY FROM EXTERNAL NETWORK.

MANAGED VIA TOUCH SCREEN 7" AND REMOTE SETTING.

FOOTSWITCH FUNCTIONING INCLUDED.

VERSIONS

UNICA V – VALIDABLE PNEUMATIC IMPULSE SEALER

UNICA VV – VALIDABLE PNEUMATIC IMPULSE SEALER WITH VACUUM/GAS FLUSHING OPTION

TABLE TOP VERSION

COMPLETE WITH MOTORIZED OR MECHANICAL SUPPORT VERSION

PACKAGING LINE VERSION VERSION

GANDUS UNICA

**PNEUMATIC IMPULSE SEALER
ISO 11607.2 FULLY VALIDATABLE**

VENTURI AIR SUCTION SYSTEM

TRACEABILITY FROM EXTERNAL NETWORK

7" COLOUR TOUCH SCREEN AND REMOTE SETTING

VIA APP WITH NO CABLE CONNECTIONS

ADVANTAGES AND BENEFITS

- TOP PERFORMING CONTROL OF ALL CRITICAL SEALING PARAMETERS FOR AN UTMOST PRECISE VALIDATION PROCESS
- STAINLESS STEEL CONSTRUCTION FOR OPERATING IN HIGH DEMANDING ENVIRONMENTS WITH TOP QUALITY REQUIREMENTS
- 7" SETTING COLOUR TOUCH SCREEN
- ROPEX CONTROLLER
- USER FRIENDLY INTERFACE SOFTWARE
- STORAGE OF UP TO 64 PRE-SET SEAL PARAMETER SETTINGS
- VERY ACCURATE VENTURI AIR SUCTION SYSTEM VIA 1 NOZZLE WITH SETTABLE POSITION FROM 0-150 MM LONG AND SUCTION ON EVEN WHEN THE NOZZLE IS IN RETRACTION PHASE
- TRACEABILITY FROM EXTERNAL NETWORK.
- DATA EXCHANGE IN/OUT VIA LAN NET, COMMUNICATION PROTOCOL MODBUS TCP/IP AND VIA USB PENDRIVE
- MANAGED VIA TOUCH SCREEN 7" AND REMOTE SETTING.
- ULTIMATE WORKING FLEXIBILITY: ADJUSTABLE WORKING HEIGHT, INCLINATION, TABLE POSITION

Mechanical support

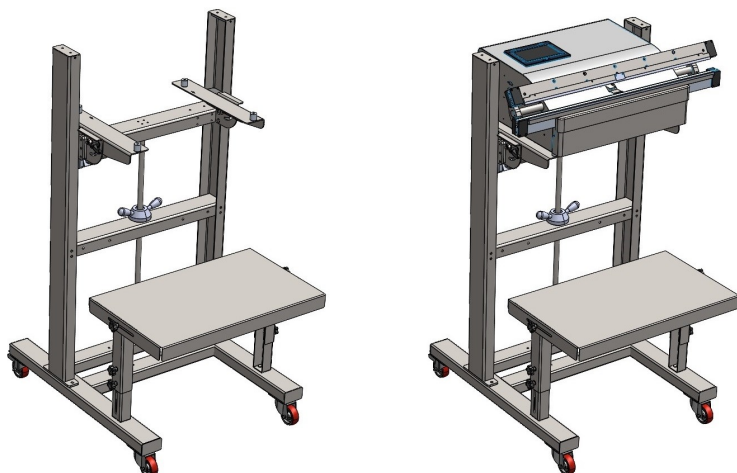

Motorized support

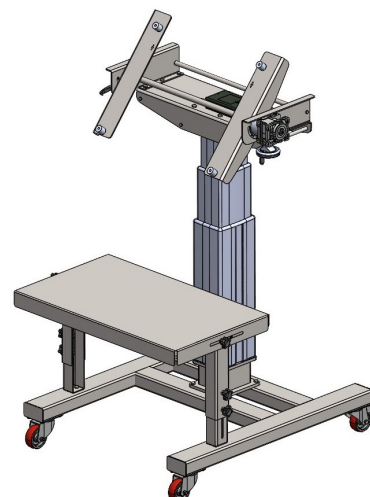

GANDUS UNICA

DIFFERENT SETTINGS TO MATCH ALL MOST SPECIFIC PACKAGING REQUIREMENTS

ADJUSTABLE WORKING HEIGHT



ADJUSTABLE WORKING INCLINATION

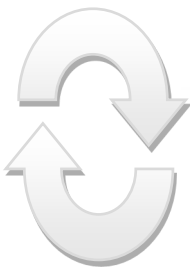

ADJUSTABLE TABLE POSITION

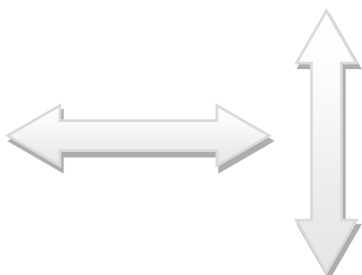

GANDUS UNICA

TOUCH SCREEN PANEL

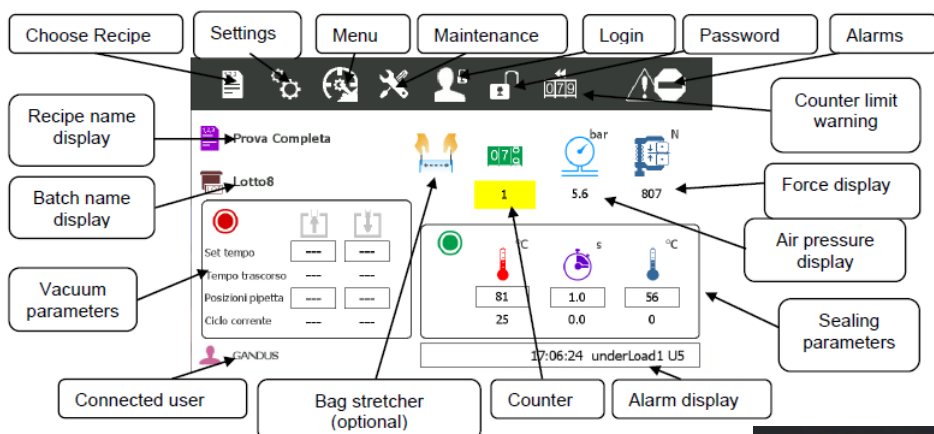

VACUUM NOZZLE

THE VENTURI AIR SUCTION SYSTEM WORKS WITH A SPECIAL MOTORIZED WITH ENCODER NOZZLE, THAT CAN BE SET IN DIFFERENT POSITIONS, ACCORDING TO THE MOST SPECIFIC PACKAGING REQUIREMENTS.

AISI 316L STAINLESS STEEL CONSTRUCTION.

DOUBLE POSITION SETTING FOR SUCTION PIPETTE.

POSSIBILITY OF SUCTION / GAS FLUSHING IN RETRACTION.

UP TO 6 SUCTION/FLUSHING CYCLES.



GANDUS UNICA V

VALIDATABLE PNEUMATIC IMPULSE SEALER

TECHNICAL FEATURES	
KIND OF SEALER	VALIDATABLE PNEUMATIC IMPULSE SEALER
MODEL	UNICA 610 V / UNICA 810 V / UNICA 1010 V/ UNICA 1210 V
DIMENSIONS WxDxH	UNICA 610 V -730x600x280 MM UNICA 810 V -930x600x280 MM UNICA 1010 V -> 1130x600x280 MM UNICA 1210 V -> 1230x600x280 MM
WEIGHT (WITHOUT ACCESSORIES)	UNICA 610 V -51 KG UNICA 810 V -53 KG UNICA 1010 V - 56 KG UNICA 1210 V - 58 KG
SEALING LENGTH	UNICA 610 V -610 MM UNICA 810 V -810 MM UNICA 1010 V - 1010 MM UNICA 1210 V - 1210 MM
SEALING HEIGHT	8 MM
KIND OF SEALING	FLAT SEALING - DOUBLE SEALING BAR
ARCHITECTURE HARDWARE	ROPEX RES 5009 + GANDUS EMBEDDED BOARD + HMI COLOUR TOUCH SCREEN 7"
EXTERNAL CONNECTIONS	1 RJ45 (ETHERNET) PORT, 1 USB PORT, 1 RS232 PORT,
CYCLE START COMMAND	VIA ELECTRIC PEDAL
SOFTWARE LOGIC	INTUITIVE ICON-BASED MENU
FUNCTIONING	ELECTRIC / PNEUMATIC
CONSTRUCTION	AISI 304 STAINLESS STEEL AND ALUMINIUM - AISI 304 STAINLESS STEEL FRAME
POWER	230 V – 1PH – 50/60HZ 115 V – 1PH – 50/60HZ
MAX POWER CONSUMPTION	UNICA 610 V - 1400 W UNICA 810 V - 1800 W UNICA 1010 V - 2100 W UNICA 1210 V - 2400 W
PNEUMATIC	0.6 MPA (6 BAR)
ACOUSTIC EMISSION LEVEL	< 70 dB(A)
PACKAGING STANDARDS	ISO 11607-2:2020 / ISO / TS 16775 / EN 868-5:2019 / DIN 58953-7

GANDUS UNICA V

VALIDATABLE PNEUMATIC IMPULSE SEALER

TECHNICAL FEATURES		
MACHINE SETTINGS	HMI REMOTE ACCESS AND MANAGEMENT VIA VNC DATA EXCHANGE IN/OUT THROUGH PROTOCOL MODBUS TCP/IP	
RECIPES	NUMBER NAME	64 RECIPES 20 ALPHANUMERIC CHARACTERS
OPERATORS	NUMBER NAME	40 OPERATOR NAMES WITH ADJUSTABLE ACCESS LEVELS AND PASSWORDS 20 ALPHANUMERIC CHARACTERS
BATCH	NUMBER NAME	40 CODICI BATCH ALFANUMERICI 20 ALPHANUMERIC CHARACTERS
RECIPES / OPERATORS / BATCH	SAVING	THROUGH HMI IN/OUT VIA LAN NET AND COMMUNICATION PROTOCOL MODBUS TCP/IP IN/OUT VIA USB PENDRIVE
PROCESS PARAMETERS	SEALING TEMPERATURE RANGE TOLERANCE RANGE	40 – 220 °C +/- 5 °C
	SEALING FORCE RANGE	750 – 1050 N
	SEALING TIME RANGE	0 – 20 s
	COOLING RANGE	40 – 220 °C
WORKING CYCLES COUNTER	MODE	INCREASING AFTER COUNTING SETTING DECREASING AFTER COUNTING SETTING UNLIMITED STOP AFTER COUNTING RESTART AFTER COUNTING
BUZZER	MODE	GENERAL SOUNDS OR ALARMS ONLY
LANGUAGE	MODE	MULTILANGUAGE MENU (ITALIAN, ENGLISH, OTHER LANGUAES AVAILABLE)

GANDUS UNICA V

VALIDATABLE PNEUMATIC IMPULSE SEALER

TECHNICAL FEATURES UNICA V		
CALIBRATION	CALIBRATION	SEALING TEMPERATURE
VALIDATION & TRACEABILITY	PARAMETERS CONTROL (STOP WITH ALARM)	SEALING TEMPERATURE SEALING TIME SEALING FORCE POWER AIR PRESSURE TRACEABILITY ANOMALIES DIAGNOSTIC ANOMALIES
	MACHINE ONBOARD USB PEN DRIVE EXTERNAL NETWORK	MACHINE ID SEALING TEMPERATURE SEALING TIME SEALING FORCE COOLING TEMPERATURE OPERATOR (USER) BATCH DATE HOUR POUCH NUMBER FIRMWARE AND SOFTWARE VERSIONS ERROR
MACHINE LOCK FUNCTIONS	LOGIN LEVELS	2 GENERAL ACCESS LEVELS WITH PASSWORD LOGIN WITH BARCODE SCANNER (OPTION)
	MACHINE LOCK / UNLOCK	POSSIBLE FOR ACCESS LEVELS
MACHINE FUNCTIONS	ALARM HISTORY	DATE/HOUR ALARM CODES/ALARM DESCRIPTIONS
	COUNTERS	MACHINE GENERAL COUNTERS AND MAINTENANCE ALARM

GANDUS UNICA V

VALIDATABLE PNEUMATIC IMPULSE SEALER

CONFORMITY	
DIRECTIVE	2006/42/CE 2014/30/UE 2014/35/UE 2015/863/EU
REFERENCES	UNI EN ISO 11607-2:2020

ACCESSORIES	
FLOOR STAND	AISI 304 STAINLESS STEEL AND ALUMINIUM CONSTRUCTIONX, MOTORIZED, ADJUSTABLE HEIGHT AND INCLINATION, WHEELED
HORIZONTAL WORKING TABLE	ADJUSTABLE IN HEIGHT HORIZONTAL WORKING TABLE – AVAILABLE ONLY WITH FLOOR STAND
INCLINED WORKING TABLE	ADJUSTABLE IN INCLINATION WORKING TABLE – AVAILABLE ONLY WITH FLOOR STAND
BAG STRETCHER	OPEN MOUTH BAG STRATCHER
CUTTING DEVICE	BAG TRIMMER
PRINTING DEVICE	LABEL PRINTER
SCANNER	BARCODE SCANNER
VALIDATION SERVICES	IQ/OQ PEEL TEST DYE TEST SEAL CHECK CALIBRATION

GANDUS UNICA VV

VALIDATABLE PNEUMATIC IMPULSE SEALER WITH VACUUM/GAS FLUSHING OPTION

TECHNICAL FEATURES	
KIND OF SEALER	VALIDATABLE PNEUMATIC IMPULSE SEALER WITH VACUUM/GAS FLUSHING OPTION
MODEL	UNICA 610 VV / UNICA 810 VV / UNICA 1010 VV/ UNICA 1210 VV
DIMENSIONS WxDxH	UNICA 610 VV -730x600x280 MM UNICA 810 VV -930x600x280 MM UNICA 1010 VV - 1130x600x280 MM UNICA 1210 VV - 1230x600x280 MM
WEIGHT (WITHOUT ACCESSORIES)	UNICA 610 VV -57 Kg / UNICA VV 810 -60 Kg UNICA 1010 VV - 63 Kg / UNICA VV 1210 - 65 Kg
SEALING LENGTH	UNICA 610 VV -610 MM / UNICA 810 VV -810 MM UNICA 1010 VV - 1010 MM / UNICA 1210 VV - 1210 MM
SEALING HEIGHT	8 MM
KIND OF SEALING	FLAT SEALING - DOUBLE SEALING BAR
ARCHITECTURE HARDWARE	ROPEX RES 5009 + GANDUS EMBEDDED BOARD + HMI COLOUR TOUCH SCREEN 7"
EXTERNAL CONNECTIONS	1 RJ45 (ETHERNET) PORT, 1 USB PORT, 1 RS232 PORT
CYCLE START COMMAND	VIA ELECTRIC PEDAL
SOFTWARE LOGIC	INTUITIVE ICON-BASED MENU
FUNCTIONING	ELECTRIC / PNEUMATIC
VACUUM SYSTEM	VENTURI AIR SUCTION SYSTEM
VACUUM / GAS FLUSHING	SUCTION NOZZLE HANDLING BY MOTOR WITH ENCODER SINGLE OR DOUBLE SUCTION NOZZLE PLACEMENT POSSIBILITY OF SUCTION / GAS FLUSHING IN RETRACTION UP TO 6 SUCTION/FLUSHING CYCLES
WORKING CYCLES	SEALING; VACUUM AND/OR GAS FLUSHING + SEALING; VACUUM AND/OR GAS FLUSHING
CONSTRUCTION	AISI 304 STAINLESS STEEL AND ALUMINIUM - AISI 304 STAINLESS STEEL FRAME AISI 316L STAINLESS STEEL SUCTION NOZZLE
POWER	230 V – 1PH – 50/60Hz; 115 V – 1PH – 50/60Hz
MAX POWER CONSUMPTION	UNICA 610 -1400W/UNICA 810 -1800W; UNICA 1010 - 2100W;UNICA 1210 - 2400W
PNEUMATIC	0.6 MPA (6 BAR)
POWER GAS	MAX. 0.1 MPA (1 BAR)
ACOUSTIC EMISSION LEVEL	SUCTION/FLUSHING OFF: < 70 DB(A); SUCTION/FLUSHING ON: ≤ 85 DB(A)
PACKAGING STANDARD	ISO 11607-2:2020 / ISO/TS 16775 / EN 868-5:2019 / DIN 58953-7

GANDUS UNICA VV

VALIDATABLE PNEUMATIC IMPULSE SEALER WITH VACUUM/GAS FLUSHING OPTION

TECHNICAL FEATURES		
MACHINE SETTINGS	HMI REMOTE ACCESS AND CONTROL VIA VNC DATA EXCHANGE IN/OUT VIA MODBUS TCP/IP PROTOCOL	
RECIPES	NUMBER NAME	64 RECIPES 20 ALPHANUMERIC CHARACTERS
OPERATORS	NUMBER NAME	40 OPERATOR NAMES WITH ADJUSTABLE ACCESS LEVELS AND PASSWORDS 20 ALPHANUMERIC CHARACTERS
BATCH	NUMBER NAME	40 ALPHANUMERIC BATCH CODES 20 ALPHANUMERIC CHARACTERS
RECIPES / OPERATORS / BATCH	SAVINGS	VIA HMI IN/OUT VIA LAN AND MODBUS TCP/IP COMMUNICATION PROTOCOL IN/OUT THROUGH USB PENDRIVE
PROCESS PARAMETERS	VACUUM TIME ADJUSTMENT RANGE	0 – 100 SEC.
	DISCHARGE TIME DEL GAS ADJUSTMENT RANGE	0 – 100 SEC.
	NOZZLE POSITION ADJUSTMENT RANGE	0 – 150 MM
	SEALING TEMPERATURE RANGE TOLERANCE RANGE	40 – 220 °C +/- 5 °C
	SEALING FORCE RANGE	750 – 1050 N
	SEALING TIME RANGE	0 – 20 s
	COOLING RANGE	40 – 220 °C
WORK CYCLE COUNTER	MODE	INCREASING AFTER COUNTING SETTING DECREASING AFTER COUNTING SETTING UNLIMITED STOP AFTER COUNTING RESTART AFTER COUNTING

GANDUS UNICA VV

VALIDATABLE PNEUMATIC IMPULSE SEALER WITH VACUUM/GAS FLUSHING OPTION

TECHNICAL FEATURES		
BUZZER	MODE	GENERAL SOUNDS OR ALARM SOUNDS ONLY
LANGUAGE	MODE	MULTILANGUAGE MENU (ITALIAN, ENGLISH, OTHER LANGUAGES AVAILABLE)
CALIBRATION	CALIBRATION	SEALING TEMPERATURE
VALIDATION & TRACEABILITY	PARAMETERS CONTROL (STOP WITH ALARM)	SEALING TEMPERATURE SEALING TIME SEALING FORCE POWER AIR PRESSURE TRACEABILITY ANOMALIES DIAGNOSTIC ANOMALIES
ADJUSTABLE PARAMETERS	ON BOARD USB PEN DRIVE EXTERNAL NETWORK	MACHINE ID SEALING TEMPERATURE SEALING TIME SEALING FORCE COOLING TEMPERATURE OPERATORE (USER) BATCH DATE HOUR POUCH NUMBER FIRMWARE AND SOFTWARE VERSIONS ERROR
MACHINE LOCK FUNCTIONS	LOGIN LEVELS	2 GENERAL ACCESS LEVELS WITH PASSWORD LOGIN WITH BARCODE SCANNER (OPTION)
	MACHINE LOCK/UNLOCK	AVAILABLE ACCESS LEVELS
MACHINE FUNCTIONS	ALARMS HISTORY	DATE/HOUR ALARM CODES/ALARM DESCRIPTION
	COUNTERS	MACHINE GENERAL COUNTERS AND MAINTENANCE ALARM

GANDUS UNICA VV

VALIDATABLE PNEUMATIC IMPULSE SEALER WITH VACUUM/GAS FLUSHING OPTION

CONFORMITY	
DIRECTIVES	2006/42/CE 2014/30/UE 2014/35/UE 2015/863/EU
REFERENCES	UNI EN ISO 11607-2:2020
ACCESSORIES	
FLOOR STAND	AISI 304 STAINLESS STEEL AND ALUMINIUM CONSTRUCTIONX, MOTORIZED, ADJUSTABLE HEIGHT AND INCLINATION, WHEELED
HORIZONTAL WORKING TABLE	ADJUSTABLE IN HEIGHT HORIZONTAL WORKING TABLE – AVAILABLE ONLY WITH FLOOR STAND
INCLINED WORKING TABLE	ADJUSTABLE IN INCLINATION WORKING TABLE – AVAILABLE ONLY WITH FLOOR STAND
BAG STRETCHER	OPEN MOUTH BAG STRATCHER
VACUUM SENSOR	VACUUM PRESSURE VISUALIZATION
CUTTING DEVICE	BAG TRIMMER
PRINTING DEVICE	LABEL PRINTER
SCANNER	BARCODE SCANNER
VALIDATION SERVICES	IQ/OQ PEEL TEST DYE TEST SEAL CHECK CALIBRATION